

DAVIS COMMERCE CENTER

22703 72nd Ave S, Suite A101 Kent, WA 98032

Available August 1, 2025

Warehouse Space



Property Specifications

- 24,469 SF Total
- 1,660 SF Office
- 200 Amps 277/480v power
- HVAC in office area
- 23' clear height
- 7 DH, 1 GL ramp

Property Features

- West Valley Highway Visibility
- Excellent freeway access to Highway 167 & I-5
- Monitored Video Surveillance & Security
- Cable access available through Comcast



DAVIS COMMERCE CENTER

DPI Davis Property & Investment

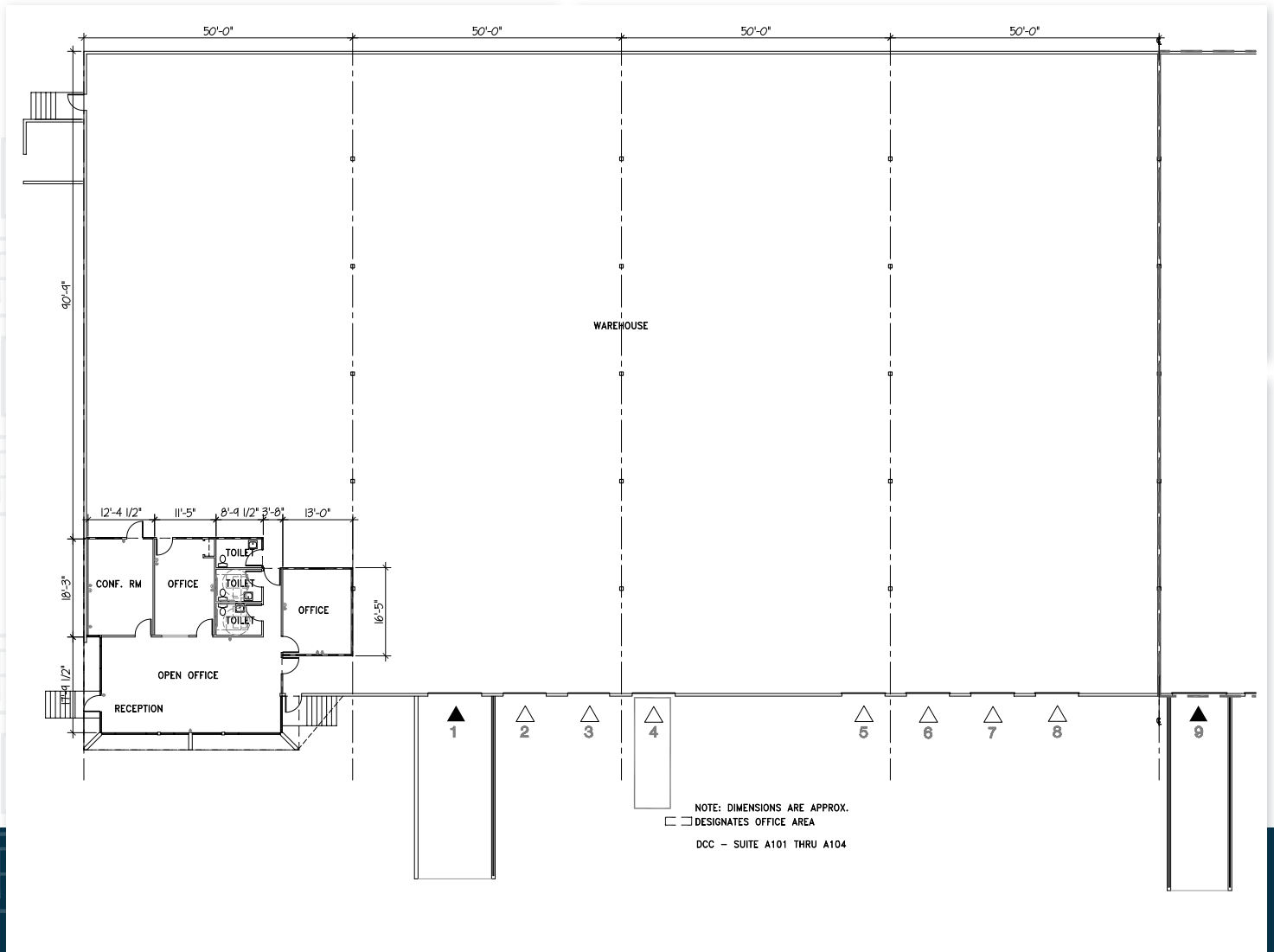

Contact Kidder Mathews for more info:

Travis Stanaway
206-248-6526
travis.stanaway@kidder.com

Dane Dahline
206-248-6519
dane.dahline@kidder.com

Lisa Rowe
206-777-5122
lisar@dpillc.com

The information provided in this document should be independently verified on any material matter represented herein.

Owned & Operated by:

DPI Davis Property & Investment

Leasing by:

km Kidder Mathews

dpillc.com